

Stainless Steel Ball Valves

G Series Investment Cast Stainless Steel Ball Valves

G2



- Full port
- NPT ends to ANSI B1.20.1
- Two piece body
- Blowout-proof stem
- Adjustable packing gland
- Locking lever handle
- Actuator mounting pad
- 2000 PSI, W.O.G. 1/4" to 1"
- 1500 PSI, W.O.G. 1 1/4" to 2"
- 1000 PSI, W.O.G. 2 1/2" to 3"

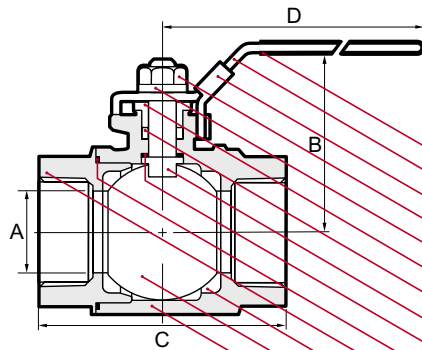
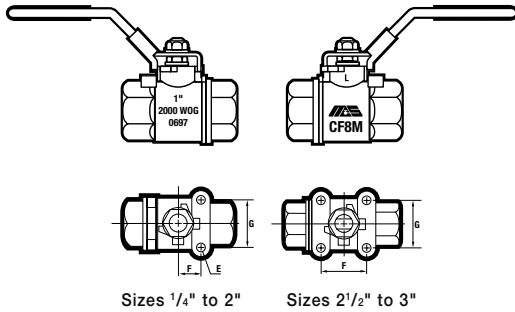

NAME / MATERIAL
1. Handle Grip / Vinyl
2. Handle / Stainless Steel 304 - A276
3. Locking Device / Stainless Steel 304 - A276
4. Handle Nut / Stainless Steel 304 - A 276
5. Stem Washer / Stainless Steel 304 - A276
6. Gland Nut / Stainless Steel 304 - A276
7. Packing / PTFE
8. Stem / Stainless Steel 316 / A276
9. Thrust Washer / Reinforced Teflon 15% GFT
10. Gasket / PTFE
11. Cap / Stainless Steel 316 - CF8M
12. Seat / Reinforced Teflon 15% GFT
13. Ball / SS 316 - A 276
14. Body / Stainless Steel 316 - CF8M

- Markings to MSS-SP25
- Available with Oval handle for size range: 1/4"-2"
- Material test results & inspection certificates available upon request
- CRN numbers available upon request
- 1/2" to 2" mounting pads are tapped, 1/4" and 3/8" have reserve holes cast in, 2 1/2" and 3" are dimpled. Recommended tapping sizes are listed for reference only.

D I M E N S I O N S										
size	8	10	15	20	25	32	40	50	65	80
mm/in	1/4	3/8	1/2	3/4	1	1 1/4	1 1/2	2	2 1/2	3
A	9.60	9.60	12.70	20.00	25.00	32.00	38.00	50.80	65.00	78.00
mm/in	0.374	0.374	0.500	0.787	0.984	1.260	1.496	2.000	2.559	3.071
B	54.00	54.00	57.00	65.50	69.50	82.50	88.00	105.00	138.00	148.00
mm/in	2.130	2.130	2.240	2.580	2.740	3.250	3.460	4.130	5.430	5.830
C	57.60	57.60	62.00	72.50	86.00	94.00	116.00	134.00	164.00	180.00
mm/in	2.264	2.264	2.441	2.854	3.386	3.700	4.567	5.276	6.457	7.086
D	103.50	103.50	103.50	125.00	125.00	158.00	158.00	181.00	252.00	252.00
mm/in	4.075	4.075	4.075	4.921	4.921	6.220	6.220	7.126	9.921	9.921
E	*	*	M6	M6	M6	M8	M8	M8	†	†
mm/in	12.73	12.73	12.73	14.85	14.85	17.68	24.75	24.75	36.05	36.05
F	0.501	0.501	0.501	0.585	0.585	0.696	0.974	0.974	1.419	1.419
mm/in	25.45	25.45	25.45	29.70	29.70	35.35	49.50	49.50	72.10	72.10
G	1.002	1.002	1.002	1.169	1.169	1.392	1.949	1.949	2.839	2.839
mm/in	7.0	7.0	15.0	45.0	65.0	125.0	175.0	380.0	500.0	900.0
CV	0.260	0.250	0.313	0.555	0.795	1.330	2.013	3.550	6.250	9.370
weights	0.572	0.550	0.689	1.221	1.749	2.926	4.429	7.810	13.750	20.614
kg/lb										

* Untapped
† dimpled at drilling location

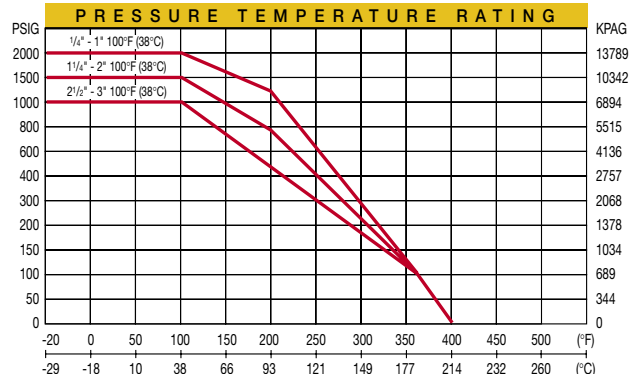

Section D
Stainless Trailer Parts

Stainless Steel Relief Valves

Models 264, 265, 266, 267, 264P 265P, 266P, 267P

Non-Code Liquid Relief, ASME Section VIII, Air/Gas and Steam, National Board Certified, Safety and Relief Valves



Pressure and Temperature Limits¹

Model 264:

4 to 3300 psig [0.28 to 227 barg]
-20° to 600°F [-29° to 316°C]

Model 266:

4 to 3300 psig [0.28 to 227 barg]
-320° to 600°F [-195° to 316°C]

Model 265:

4 to 3300 psig [0.28 to 227 barg]
-20° to 750°F [-29° to 399°C]

Model 267:

4 to 3300 psig [0.28 to 227 barg]
-320° to 750°F [-195° to 316°C]

Pressures listed are for female NPT inlets only, see chart on page 56 for male NPT.

Maximum back pressure 400 psig
[27.6 barg]

Applications

- Protection of pumps, compressors, pressure vessels or systems handling corrosive fluids or vapors at high pressure and/or temperature.
- Sentinel (warning) on steam equipment.

Features and Benefits

- **Top guided design** offers high capacity with 0.110 in² [0.710 cm²] orifice area.
- **Ball bearing pivot between disc and spring** corrects misalignment and compensates for spring side thrust.

- **Every valve is 100% tested/inspected** for pressure setting and leakage.
- **Standard outlet** with 1-inch Female NPT.

Model Descriptions

Model 264: CS housing with 316 SS trim (nozzle and disc), SS spring. Pressure-tight cap.

Model 265: Same as Model 264 except high-temperature alloy spring (temperatures to 750°F [400°C]).

Model 266: Same as Model 264 except all 316 SS materials.

Model 267: Same as Model 266 except high-temperature alloy spring (temperatures to 750°F [399°C]).

Model 264P: Same as Model 264 with pressure-tight packed lift lever.

Model 265P: Same as Model 265 with pressure-tight packed lift lever.

Model 266P: Same as Model 266 with pressure-tight packed lift lever.

Model 267P: Same as Model 267 with pressure-tight packed lift lever.

Notes

1. Pressures are female NPT inlets only. For maximum pressures for male NPT inlets see chart on page 56.
2. ASME standard valves for air or steam service must have lift lever.
3. Due to the capacity of this valve, thrust calculations should be reviewed and valve supported accordingly.